

BENCH

Designer: SPARK - Cameron Johnston



SLAT OPTIONS

- Oiled hardwood
- Composite
- Clear anodised aluminium
- Wood grain aluminium

FRAME OPTIONS

- Hot dip galvanised mild steel

FRAME FINISHES

- Hot dip galvanised
- Powdercoat

INSTALLATION

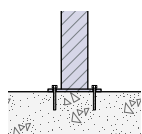

Bolt Down

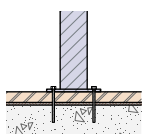

Bolt Through

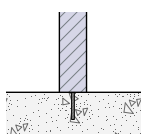

Concealed Fix

FIXINGS

- 12mm fixings for 14mm for diameter holes

Alternative materials and finishes available on request

GEMTREE BENCH

SPECIFICATIONS

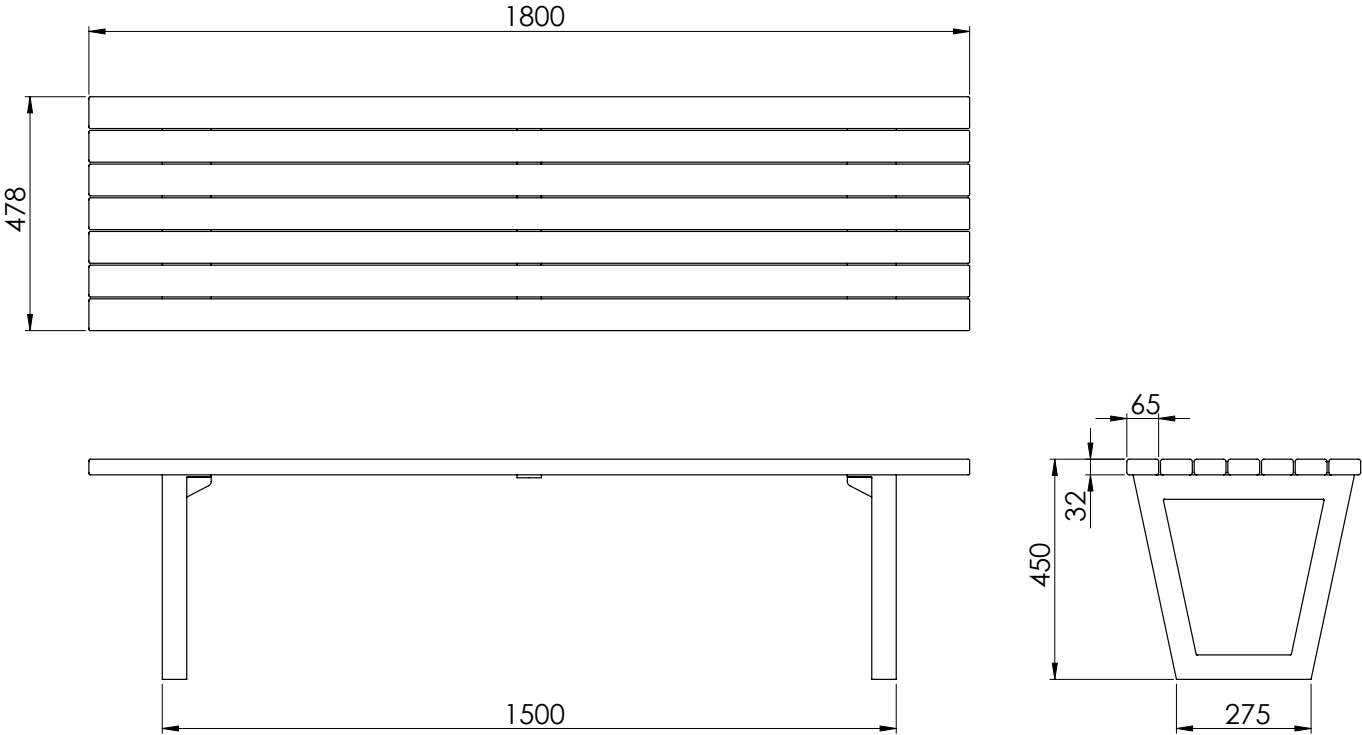

Measurements are in millimetres. Drawings are not to scale.
Dimensions shown are for timber slat option.

PRODUCT CODE	FRAME FINISH	SLAT OPTION & SIZE (mm)
GMT002-HDG-GV-T	Hot Dip Galvanised	65x32 Oiled hardwood timber
GMT002-HDG-GV-C	Hot Dip Galvanised	60x40 Composite
GMT002-HDG-GV-A	Hot Dip Galvanised	65x35 Clear anodised aluminium
GMT002-HDG-GV-W	Hot Dip Galvanised	65x35 Wood grain aluminium
GMT002-HDG-PC-T	Powdercoated	65x32 Oiled hardwood timber
GMT002-HDG-PC-C	Powdercoated	60x40 Composite
GMT002-HDG-PC-A	Powdercoated	65x35 Clear anodised aluminium
GMT002-HDG-PC-W	Powdercoated	65x35 Wood grain aluminium